

# Lift Truck/Pallet Jack

## CLS-420 Wired Version

Cargo Lift Scale



### STANDARD FEATURES

- Capacities: 5,000 lb or 8,000 lb
- Two 5,000 lb stainless steel load cells
- Mechanical overload stops promote scale longevity and accuracy
- Reinforced cover plate protects load cells and junction box from debris
- Welded centering pin ensures proper alignment and prevents scale from lateral movement
- Two-channel iQUBE®
- Cal-Match™ algorithm automatically trims and calibrates scale
- Coiled interface cable from scale to indicator

### 420 Plus Indicator

- Stainless steel enclosure
- Two-piece mounting assembly with vibration isolators
- Six digit, 0.8in red LED display
- Full numeric keypad for manual tare entry
- Accumulate weight function for multiple skid loads
- RS-232 port (time and date, weight)
- Full front panel digital calibration
- On/Off button for forklift battery conservation

### APPROVALS



Measurement  
Canada  
Approved  
(Pending)

### SPECIFICATIONS

#### SCALE CAPACITY:

5,000lb, 8,000lb

#### SCALE POWER:

Supplied by indicator through coiled interface cable

#### SCALE MATERIAL/FINISH:

Painted Mild Steel

#### APPROVAL:

NTEP Certified per H-44 at 1,000 divisions, Class III, COC # 06-074 (5,000lb only)  
Measurement Canada - pending (5,000lb only)

#### 420 PLUS DISPLAY:

0.8in (20mm), 6-digit Super Red Light Emitting Diode (LED), 7-segment digits

#### 420 POWER - DC:

Line voltages: 10-60VDC DC input  
Power consumption: 0.75A Max  
Fused at 5.0A

#### 420 STATUS ANNUNCIATORS:

Designators for: center of zero, stand still, gross, net, lb, kg, count, tare

#### 420 OPERATING TEMPERATURE:

Legal: 14°F to 104°F  
(-10°C to 40°C)  
Industrial: 14°F to 122°F  
(-10°C to 50°C)

#### WARRANTY:

Two-year limited warranty

## CLS-420 Wired Version

Cargo Lift Scale

| PART #                                | SIZE, CAPACITY       | FORKLIFT COMPATIBILITY                     | WEIGHT        | PRICE           |
|---------------------------------------|----------------------|--|---------------|-----------------|
| CLS Forklift Scale, 420 wired version |                      |  |               |                 |
| 111033.....                           | 28 in, 5,000 lb..... | Class II, 16 in cleat style carriage.....  | 524 lb .....  | Consult factory |
| 96339.....                            | 34 in, 5,000 lb..... | Class II, 16 in cleat style carriage.....  | 539 lb .....  | Consult factory |
| 111038* .....                         | 38 in, 8,000 lb..... | Class III, 20 in cleat style carriage..... | 1144 lb ..... | Consult factory |

\*Non-NTEP

### OPTIONS/ACCESSORIES

112986..... Wireless LAN card ..... Consult factory

### Manuals

96483..... CLS-420 installation manual ..... Consult factory

96484..... CLS-420 operator card..... Consult factory

### CLS SCALE DIMENSIONS

Front view

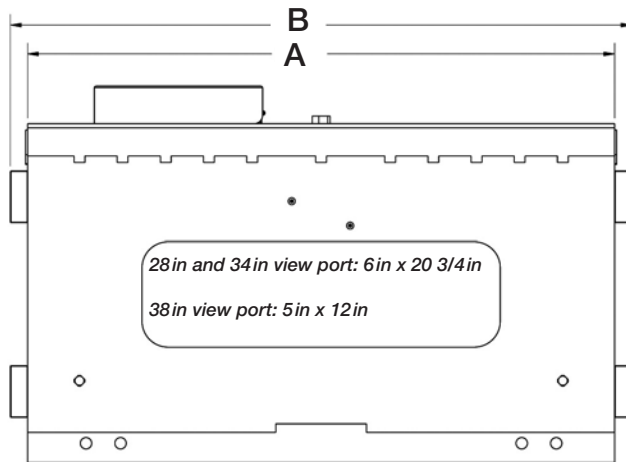

Side view

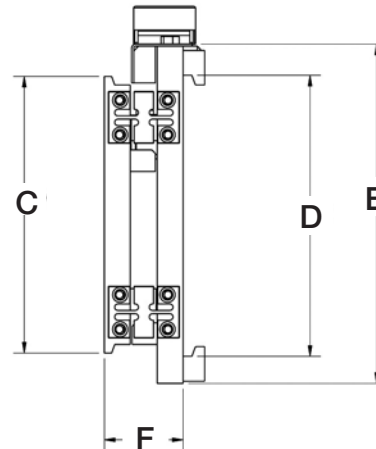

Rear view

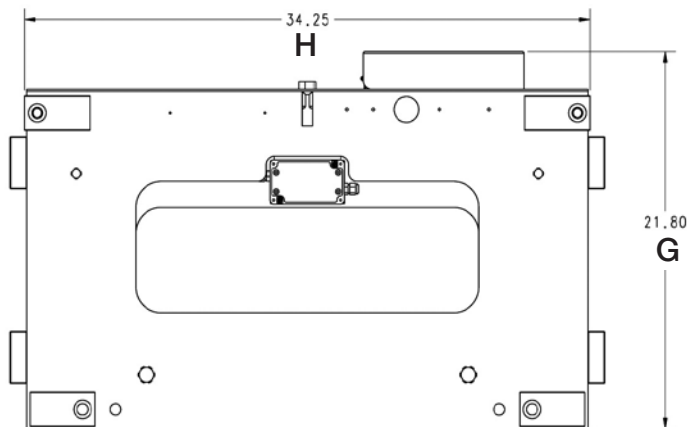

| Scale Size            | A  | B  | C  | D     | E     | F    | G     | H     |
|-----------------------|----|----|----|-------|-------|------|-------|-------|
| <b>28 in, 5000 lb</b> | 28 | 30 | 16 | 16.30 | 19.62 | 4.56 | 21.80 | 28.24 |
| <b>34 in, 5000 lb</b> | 34 | 36 | 16 | 16.30 | 19.62 | 4.56 | 21.80 | 34.24 |
| <b>38 in, 8000 lb</b> | 38 | 40 | 16 | 20.15 | 24.63 | 6.04 | 27.55 | 38    |

## CLS-420 Wireless Version

Cargo Lift Scale

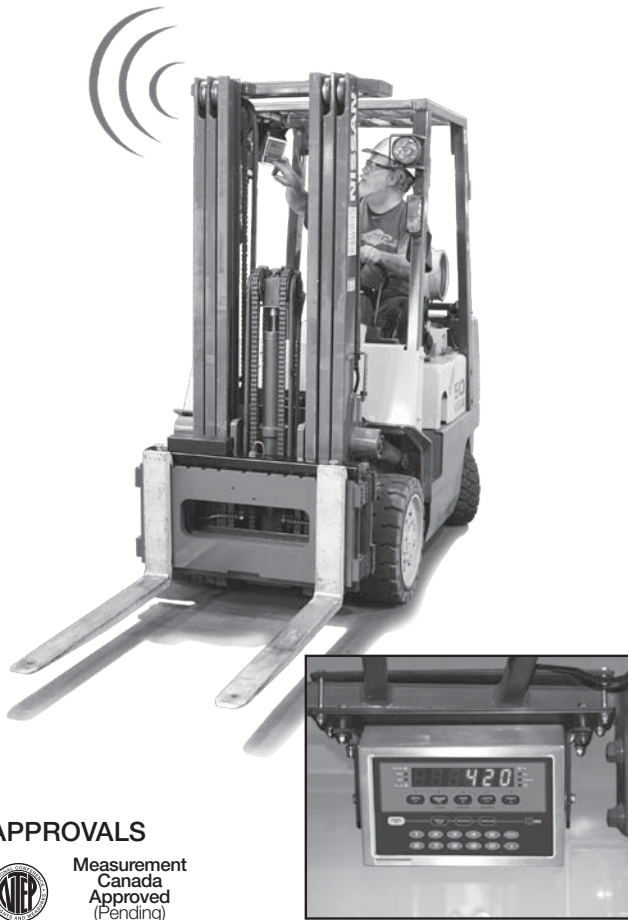

### STANDARD FEATURES

- Capacities: 5,000lb or 8,000lb
- Two 5,000lb stainless steel load cells
- Mechanical overload stops promote scale longevity and accuracy
- Reinforced cover plate protects load cells and junction box from debris
- Welded centering pin ensures proper alignment and prevents scale from lateral movement
- Two-channel iQUBE®
- Cal-Match™ algorithm automatically trims and calibrates scale
- ZigBee™ connection from scale to indicator
- Two lithium-ion smart batteries included  
Note: scale operates using one battery for 24 continuous hours and requires only eight hours to fully charge
- External battery charger

### 420 Plus Indicator

- Stainless steel enclosure
- Two-piece mounting assembly with vibration isolators
- Six digit, 0.8in red LED display
- Full numeric keypad for manual tare entry
- Accumulate weight function for multiple skid loads
- RS-232 port (time and date, weight)
- Full front panel digital calibration
- On/Off button for forklift battery conservation

### APPROVALS



Measurement  
Canada  
Approved  
(Pending)

### SPECIFICATIONS

#### SCALE CAPACITY:

5,000lb, 8,000lb

#### SCALE POWER:

Supplied by indicator through coiled interface cable

#### SCALE MATERIAL/FINISH:

Painted Mild Steel

#### APPROVAL:

NTEP Certified per H-44 at 1,000 divisions, Class III, COC # 06-074 (5,000lb only)  
Measurement Canada - pending (5,000lb only)

#### 420 PLUS DISPLAY:

0.8in (20mm), 6-digit Super Red Light Emitting Diode (LED),  
7-segment digits

#### 420 POWER - DC:

Line voltages: 10-60VDC DC input  
Power consumption: 0.75A Max  
Fused at 5.0A

#### 420 STATUS ANNUNCIATORS:

Designators for: center of zero,  
stand still, gross, net, lb, kg,  
count, tare

#### 420 OPERATING TEMPERATURE:

Legal: 14°F to 104°F  
(-10°C to 40°C)  
Industrial: 14°F to 122°F  
(-10°C to 50°C)

#### WARRANTY:

Two-year limited warranty

## CLS-420 Wireless Version

Cargo Lift Scale

| PART #                                   | SIZE, CAPACITY      | FORKLIFT COMPATIBILITY                     | WEIGHT        | PRICE           |
|--|---------------------|--|---------------|-----------------|
| CLS Forklift Scale, 420 wireless version |                     |  |               |                 |
| 111034.....                              | 28in, 5,000lb.....  | Class II, 16 in cleat style carriage.....  | 524 lb .....  | Consult factory |
| 96340.....                               | 34 in, 5,000lb..... | Class II, 16 in cleat style carriage.....  | 539 lb .....  | Consult factory |
| 111039* .....                            | 38in, 8,000lb.....  | Class III, 20 in cleat style carriage..... | 1144 lb ..... | Consult factory |

\*Non-NTEP

### OPTIONS/ACCESSORIES

112986..... Wireless LAN card ..... Consult factory

### Manuals

96483..... CLS-420 installation manual ..... Consult factory

96484..... CLS-420 operator card..... Consult factory

96315..... CLS series service & troubleshooting manual..... Consult factory

### CLS SCALE DIMENSIONS

Front view

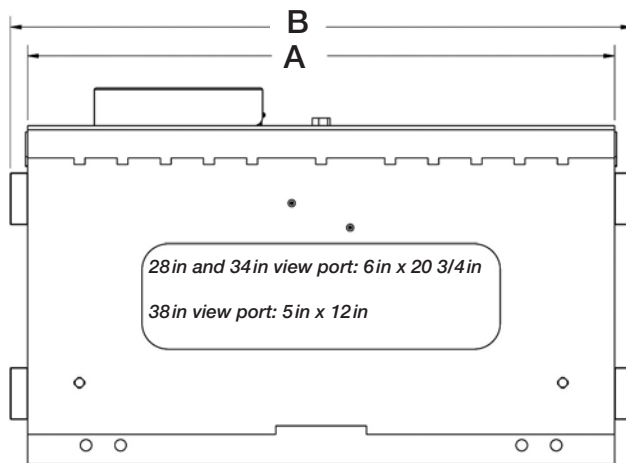

Side view

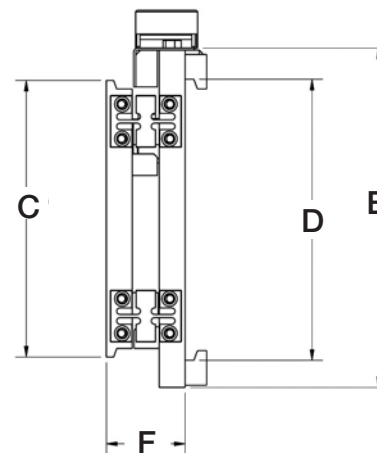

Rear view

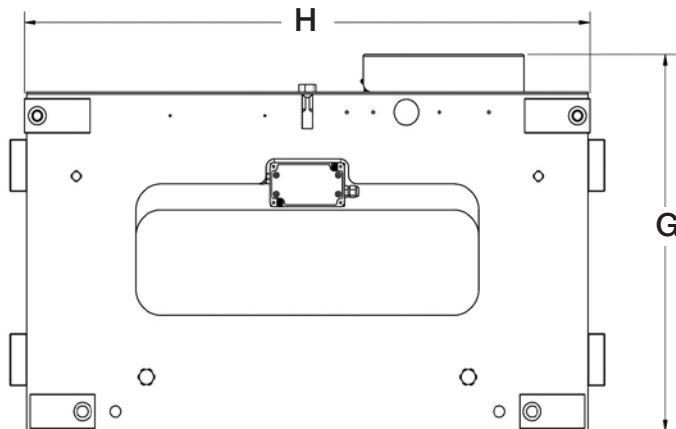

| Scale Size            | A  | B  | C  | D     | E     | F    | G     | H     |
|-----------------------|----|----|----|-------|-------|------|-------|-------|
| <b>28 in, 5000 lb</b> | 28 | 30 | 16 | 16.30 | 19.62 | 4.56 | 21.80 | 28.24 |
| <b>34 in, 5000 lb</b> | 34 | 36 | 16 | 16.30 | 19.62 | 4.56 | 21.80 | 34.24 |
| <b>38 in, 8000 lb</b> | 38 | 40 | 16 | 20.15 | 24.63 | 6.04 | 27.55 | 38    |